

## DO-IT-YOURSELF LABEL KIT FOR WOOD BOX

### Part I. Wood Box for NEDA 400/Z-985 Zenith Trans-Oceanic Battery

1. Construct a wood box using 1/8" basswood, with a length of 13 inches, width of 4 inches, and height of 2-3/8."
2. The box top is 13 inches by 4 inches by 1/8 inch.
3. With the top in place, the box should have a height of 2-1/2 inches.

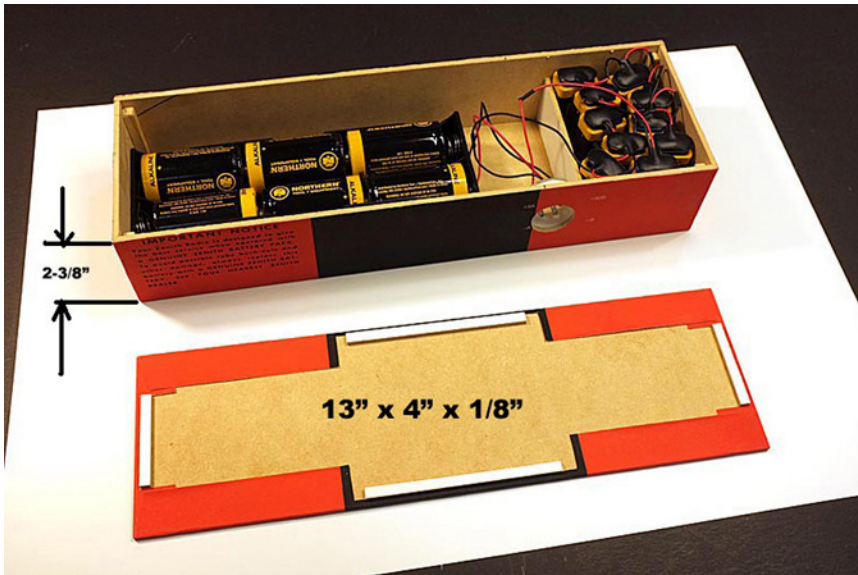

## Part 2. Instructions for Applying Labels to Wood Battery Box

### General Instructions

*Read these instructions all the way through before beginning work. It may save you some grief!*

This label set may be used with the wood Trans-Oceanic battery box built by Stan Crook or you can build your own wood box as described in Part 1. This label set is printed on Epson Presentation Paper Matte. The surface of the paper can be easily damaged. Handle carefully. Avoid moisture.

Before you begin, set up two work places, one for cutting and applying the labels to the box, and another area for spraying the labels with adhesive.



**You will need the following items:**

- Sheet of foam board or cardboard to work on
- Scissors
- Hobby knife with new #11 blades
- Ruler
- Straight Edge
- 3M 77 Spray Adhesive
- Alcohol or and towel for hand cleaning
- Old newspaper for gluing. Use a fresh sheet of newspaper for each label.

*The adhesive sets in about 30 seconds. For the first few seconds or so, you may be able to reposition the label. It is very important to practice each step several times before fitting the label to the box with adhesive. Practice! Practice! Practice!*

Keep a rag and isopropyl alcohol handy to clean adhesive from your hands. Handle the labels by the edges once you apply adhesive and work carefully, but quickly. Trial fit and trim pieces before gluing for best fit and to avoid having to trim after gluing.

### Step 1: Apply the end panels



- A. Cut out each end panel label
- B. Use a straight edge to fold over the three tabs
- C. Spray an even coat of 3M 77 Spray Adhesive over the back side of the label
- D. Apply the label. Note the orientation of the label. The Zenith logo faces the rear panel (socket side). The un-tabbed label edge fits flush with the top edge of the box.

### Step 2. Apply the front and rear panels

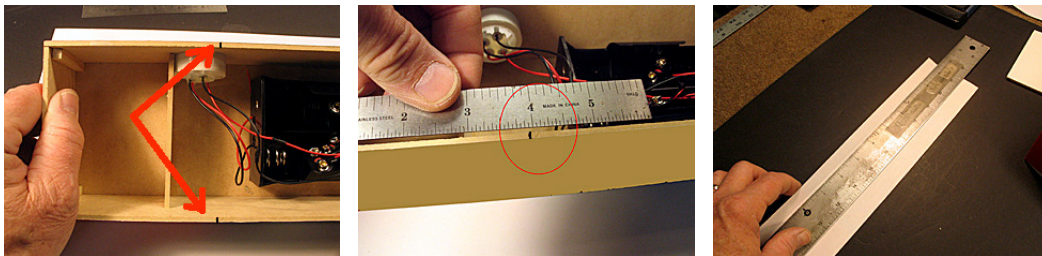

A. Make reference marks 4" from the left end of the box (end closest to socket) on the top edge of the front and rear sides of the box as shown in the photos above. This mark is used to correctly align the front and rear panel labels. ***Note: This step applies to Zenith labels only. Disregard if using another style of label.***

- B. Cut out the front panel label and fold the bottom tab over.
- C. Apply 3M 77 Spray Adhesive to the back of the label
- D. Apply the label to the front panel of the box, making sure to align the red/black demarcation with the reference mark as shown in the photo below.





- E. Pull the bottom tab of the label snug along the bottom of the box.
- F. Repeat steps B through E for the rear panel.

### Step 3. Apply the bottom panel label



- A. Cut out the bottom label. It has no tabs.
- B. Apply 3M 77 Spray adhesive to the back of the label.
- C. Apply the label to the bottom of the box with the label oriented to the rear panel (socket side) as shown in the photo above. Make sure label matches up with front and rear panel labels.

### Step 4. Apply labels to the box top

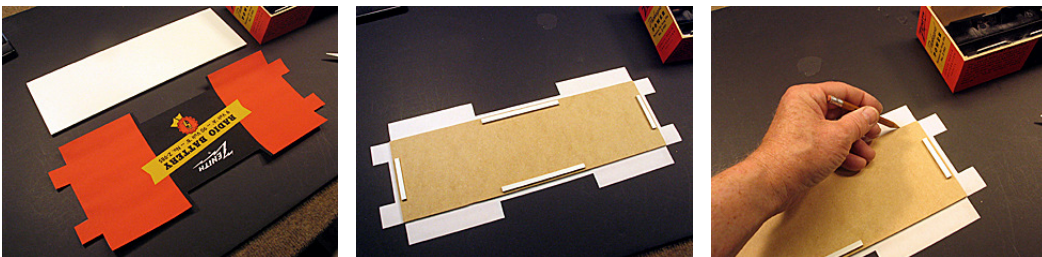

- A. Cut out the label
- B. Place the box top face down on the back side of the label as shown above.
- C. Trace the outline of the box top with a pencil. These are folding guides.

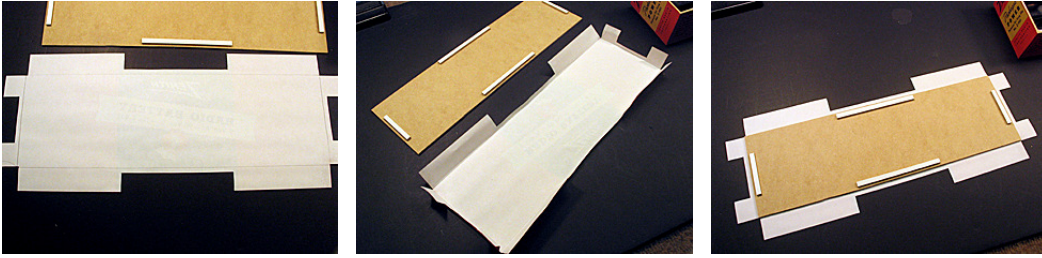

- D. Fold tabs along the lines you traced
- E. Apply 3M 77 Spray Adhesive.
- F. Lay the label flat on your work surface, glued side up, and again, carefully position the box top, top side against the glue, and press in place.

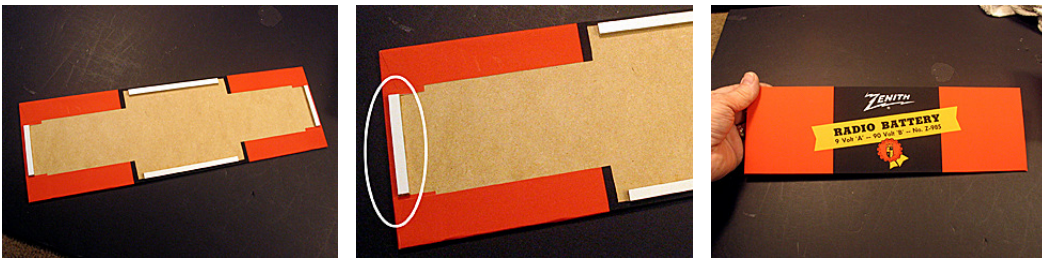

- G. Pull the end tabs snug over the bottom of the box top, then fold the side tabs over snug against the bottom. Use a finger nail or suitable tool to smooth down the tabs along the four stops that hold the box top in place.

Step 5. Cut out the radio socket hole

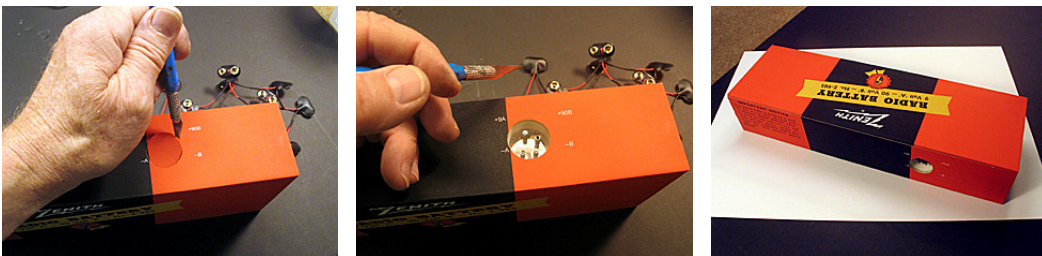

- A. Use a fresh #11 blade in a hobby knife
- B. Locate the connector socket hole. You can feel it with your finger.
- C. Insert the blade into the hole, then carefully cut open the hole, letting the hole in the box guide the blade. It is critical to use a new blade for best results.
- D. Check all seams and edges of the box to make sure the labels are smooth and adhering properly.

That's it. Your box is now ready to use. We recommend that you apply a coat of clear acrylic lacquer or any clear coating approved for inkjet prints, such as Krylon Preserve It! This will help protect your box from moisture and scuffing.

